

CLOG ZAPPER* with Applicator

Enteral Feeding Tube Declogging System

Used to clear blockages in enteral feeding tubes

Pre-mixed, pre-measured, pre-loaded system that loosens, breaks down, and dislodges clogs

For all types of feeding devices including nasogastric (NG) tubes, jejunostomy (J) tubes, percutaneous endoscopic gastrostomy (PEG) tubes, gastrostomy (G) tubes, and low-profile gastrostomy devices

How to Store:

- Once mixed use within 24 hours
- Refrigerate mixture until use



All ingredients are food-grade, generally recognized as safe by the Food and Drug Administration, and derived from plant and bacterial sources

Which Patients Should Receive a CLOG ZAPPER*?

Patients with a nasogastric (NG), jejunostomy (J), percutaneous endoscopic gastrostomy (PEG), or gastrostomy (G) tube or a low-profile gastrostomy device

Cautions

- Prior to use, ensure any visible tubing is free of kinks
- Protective eyewear is recommended. The solution can cause irritation if it gets in contact with the eyes.
- Depending on where the clog is in the feeding tube, the applicator may not reach it. This is ok. The CLOG ZAPPER* will find and clear the obstruction.
- If you have a fluid/water restriction, record the amount of fluid used with the CLOG ZAPPER*

Patients with Food Allergies

CLOG ZAPPER* contains the following food-based ingredients:

- Alpha Amylase
- Ascorbic Acid
- Cellulase
- Citric 1 Acid Hydrate
- Disodium Phosphate-Dihydrate
- Disodium Salt EDTA
- Maltodextrin
- Papain
- Potassium Sorbate
- Sodium Lauryl Sulfate
- **Tree Nuts (coconut)**

Patients Should Use the CLOG ZAPPER* upon first acknowledgement of a clogged tube

Instructions for Gastrostomy (G)-Tube Use

- Cut applicator at dot
- Discard excess tubing
- Place applicator into G-Tube's Administration set port
- Continue with NG and J-Tube instructions below

Instructions for Low-Profile Devices

- Place feeding set into Low-Profile Device following manufacturer's instructions
- Place applicator into Feeding Set
- Continue with NG and J-Tube instructions below

Nasogastric (NG) and Jejunostomy (J)-Tube Instructions

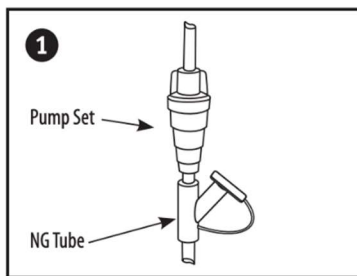

1. Turn feeding pump OFF and close roller clamp on administration set.

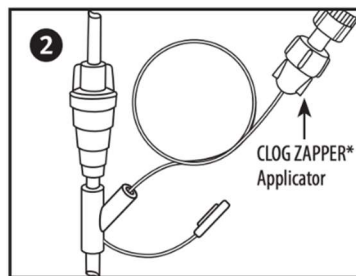

2. Remove Y-Adapter Cap and insert CLOG ZAPPER* Applicator Tubing into feeding tube.

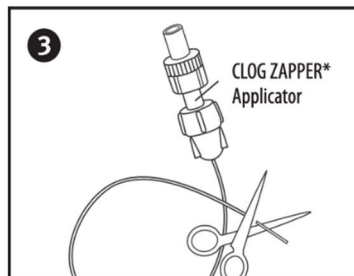

3. If it is not possible to place the Applicator all the way into the feeding tube, the distal end of the Applicator may be pressing against the clog. If this is the case, take out the Applicator and trim the Applicator tubing to the appropriate length. Do not try to break up the clog with the distal end of the Applicator.

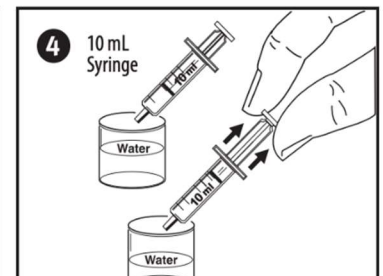

4. Remove Syringe Cap and fill the CLOG ZAPPER* Syringe to 10 ml mark with water.

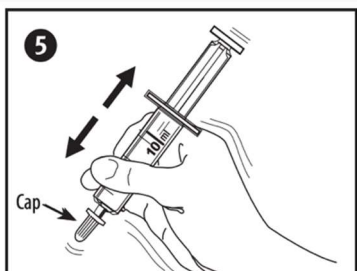

5. Replace Syringe Cap and shake vigorously for 3-5 minutes until all powder is dissolved.

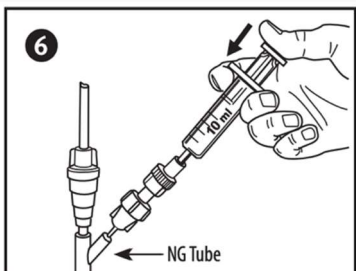

6. Gently fill tube with recommended dosage of 2-5 ml of CLOG ZAPPER* solution.

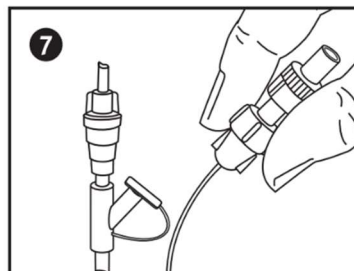

7. Remove Applicator from tube. Plug tube. Keep Applicator and Syringe together with patient if procedure must be repeated.

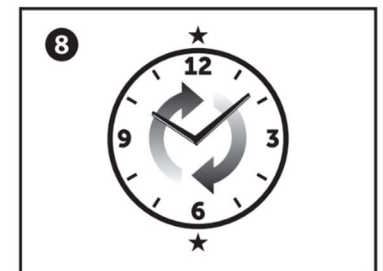

8. Keep solution in tubing for 60 minutes / 30 minutes minimum.

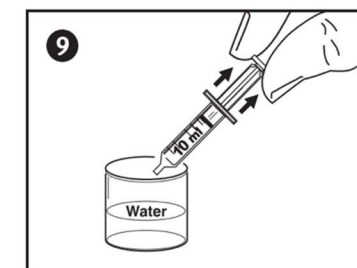

9. Fill Oral Syringe with 6 ml of water.

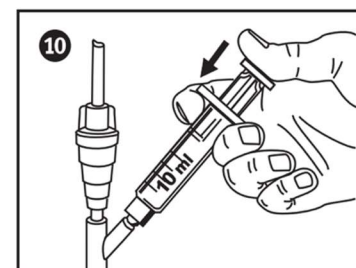

10. FLUSH! with 6 ml of water. After tube clears, dispose per institution's protocol and resume feeding.

NOTE: If the tubing cannot be flushed, repeat steps 4-9.

Check with your provider to determine how many times the process can be repeated.